



LMK 331

Screw-in Transmitter with Ceramic Sensor

- ▶ flush diaphragm
- ▶ pressure ports in stainless steel, PVC or PVDF
- ▶ accuracy:
0.25 % FSO BFSL
(0.5 % FSO IEC 60770)
- ▶ nominal pressure ranges
from 0 ... 160 mbar
up to 0 ... 60 bar

The screw-in transmitter LMK 331 has been specially designed for level and process measurement. Due to the semi-flush mounted pressure sensors the LMK 331 can also be used in viscous or contaminated media.

The ceramic sensors feature high compatibility against aggressive media. The sensor is sealed against the pressure port depending on the nominal pressure range with FKM or NBR seals as standard. Other elastomers are available.

Pressure port material is alternatively stainless steel 1.4571 (316Ti), or, for particularly aggressive media, PVDF or PVC. For process measurement applications different process connections are available on request. Additional it is possible to use the screw-in transmitter LMK 331 in explosive area (zone 0).

Preferred areas of use are:

- ▶ tank level measurement
- ▶ water and sewage treatment
- ▶ paper industry
- ▶ chemical industry

- ▶ ceramic sensor without oil-filling with high resistance against aggressive media, e.g. acids and lyes
- ▶ small thermal effects
- ▶ good long term stability
- ▶ option Ex-version:
(only for 4 ... 20 mA / 2-wire)
TÜV 03 ATEX 2006 X
- ▶ customer specific versions:
- special pressure ranges

Characteristics



LMK 331
Screw-in Transmitter

Input pressure range ¹														
Pressure port	G1 1/2"					G3/4"								
Nominal pressure gauge [bar]	0.16	0.25	0.4	0.6	1	1.6	2.5	4	6	10	16	25	40 ²	60 ²
Level [mWC]	1.6	2.5	4	6	10	16	25	40	60	100	160	250	400	600
Permissible overpressure [bar]	0.6	0.6	1.5	1.5	3	7	7	12	12	25	50	50	120	120

Output signal / Supply	
Standard	2-wire: 4 ... 20 mA / $V_S = 12 \dots 36 V_{DC}$ Ex-protection ³ : $V_S = 14 \dots 28 V_{DC}$
Options for G3/4"	3-wire: 0 ... 20 mA / $V_S = 14 \dots 36 V_{DC}$ 0 ... 10 V / $V_S = 14 \dots 36 V_{DC}$

Performance	
Accuracy	IEC 60770 ⁴ : $\leq \pm 0.5 \% FSO$ BFSL: $\leq \pm 0.25 \% FSO$
Permissible load	current 2-wire: $R_{max} = [(V_S - V_{Smin}) / 0.02] \Omega$ current 3-wire: $R_{max} = 500 \Omega$ voltage 3-wire: $R_{min} = 10 k\Omega$
Influence effects	supply: 0.05 % FSO / 10 V load: 0.05 % FSO / k Ω
Response time	< 10 msec.

Thermal effect	
Thermal error for offset and span in compensated range	$\leq \pm 0.2 \% FSO / 10 K$ -25 ... 85 °C

Electrical protection	
Short-circuit protection	permanent
Reverse polarity protection	no damage, but also no function
Electromagnetic compatibility	emission and immunity according to EN 61326
Option Ex-protection only with 4 ... 20 mA / 2-wire DX13-LMK 331	stainless steel pressure port: zone 0 ⁵ : II 1 G EEx ia IIC T4 zone 20: II 1 D T 85°C plastic pressure port G1 1/2": zone 1: II 2 G EEx ia IIC T4 zone 20: II 1 D T 85°C safety technical maximum values: $V_i = 28 V$, $I_i = 93 mA$, $P_i = 660 mW$; $C_i \leq 1 nF$, $L_i \leq 10 \mu H$

Mechanical stability	
Vibration	10 g RMS (20 ... 2000 Hz)
Shock	100 g / 11 ms

Permissible temperatures ⁶	
Medium	-25 ... 135 °C
Electronics / environment	-25 ... 85 °C Ex-protection: application in zone 0: -20 ... 60 °C application in zone 1 or higher: -25 ... 70 °C
Storage	-40 ... 100 °C

¹ G1 1/2" from 0.16 bar up to 0.4 bar; G3/4" from 0.6 bar up to 60 bar

² only possible for pressure port in stainless steel

³ Ex-protection not possible with mech. connection G3/4" with plastic pressure port

⁴ accuracy according to IEC 60770 – limit point adjustment (non-linearity, hysteresis, repeatability)

⁵ approved for atmospheric pressure from 0.8 bar up to 1.1 bar

⁶ for pressure port of PVC the maximum permissible temperature is 50 °C

LMK 331

Screw-in Transmitter

Technical Data

Mechanical connection

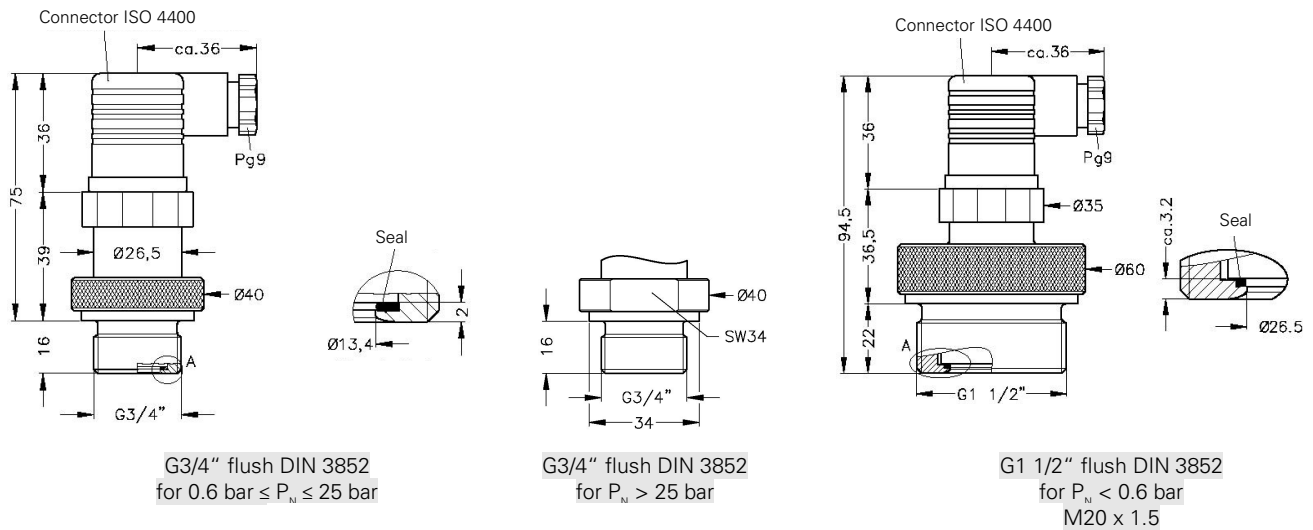

- ⇒ With PVC and PVDF versions total length increases by 3 mm (G3/4") or by 3.5 mm (G1 1/2") !
- ⇒ G3/4" with Ex-protection: total length increases by 17.5 mm!

Electrical connection

Standard

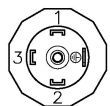
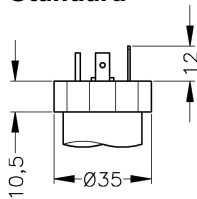

ISO 4400 (IP 65)

Optional

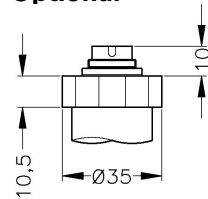

Binder Series 723 (IP 67)

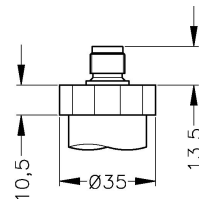

M12x1 4-pin (IP 67)

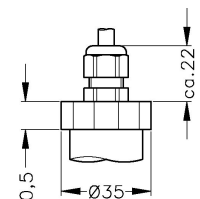

Cable gland (IP 67)^{7,8}

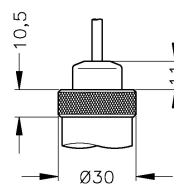

Cable outlet (IP 68)⁷

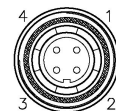
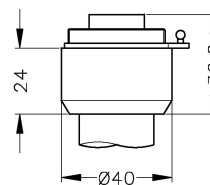

Buccaneer (IP 68)⁹

⁷ different cable types and lengths available

⁸ standard: 2m PVC cable (without ventilation tube), optionally cable with ventilation tube

⁹ for gauge pressure up to 40 bar cable with ventilation tube required

Materials		
Pressure port / housing	pressure port G 3/4"	pressure port G1 1/2"
	standard: stainless steel 1.4571 (316Ti)/ stainless steel 1.4301 (304) options ¹⁰ : PVC grey / PVC grey PVDF / PVDF	standard: stainless steel 1.4571 (316Ti)/ stainless steel 1.4305 (303) options: PVC grey / PVC grey PVDF / PVDF
Seals (media wetted)	P _N ≤ 25 bar: FKM / EPDM P _N > 25 bar: NBR others on request	
Diaphragm	ceramic Al ₂ O ₃ 96 %	
Media wetted parts	pressure port, seals, diaphragm	

Miscellaneous	
Connecting cables (by factory)	cable capacitance: signal line/shield also signal line/signal line: 160 pF/m cable inductance: signal line/shield also signal line/signal line: 1 µH/m
Current consumption	signal output current: max. 25 mA signal output voltage: max. 7 mA
Weight	approx. 150 g
Installation position	any

Pin configuration						
Electrical connection		ISO 4400	Binder 723 (5-pin)	M12x1 (4-pin)	Buccaneer (4-pin)	cable colours (DIN 47100)
2-wire-system	Supply +	1	3	1	1	white
	Supply -	2	4	2	2	brown
	Ground	ground pin	5	4	4	yellow / green (shield)
3-wire-system	Supply +	1	3	1	1	white
	Supply -	2	4	2	2	brown
	Signal +	3	1	3	3	green
	Ground	ground pin	5	4	4	yellow / green (shield)

Wiring diagrams

2-wire-system (current)

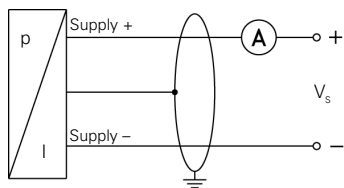

3-wire-system (current / voltage)

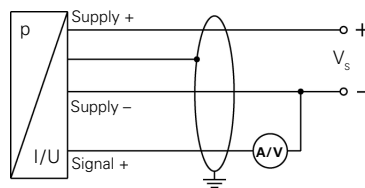

This data sheet contains product specification, properties are not guaranteed. Subject to change without notice.

¹⁰ possible for nominal pressure ranges P_N ≤ 25 bar; not possible with Ex-protection

Ordering code LMK 331

LMK 331

□□□ - □□□□ - □ - □ - □□□ - □□□□ - □ - □ - □□□□

Pressure										
gauge in bar	4	6	0							
gauge in mWC	4	6	1							
Input										
[mWC]	[bar]									
For pressure port G1 1/2"										
1,6	0,16	1	6	0	0					
2,5	0,25	2	5	0	0					
4,0	0,40	4	0	0	0					
For pressure port G3/4"										
6,0	0,60	6	0	0	0					
10	1,0	1	0	0	1					
16	1,6	1	6	0	1					
25	2,5	2	5	0	1					
40	4,0	4	0	0	1					
60	6,0	6	0	0	1					
100	10	1	0	0	2					
160	16	1	6	0	2					
250	25	2	5	0	2					
400	40	4	0	0	2					
600	60	6	0	0	2					
customer		9	9	9						
Analogue output										
4 ... 20 mA / 2-wire						1				
0 ... 20 mA / 3-wire ²						2				
0 ... 10 V / 3-wire ²						3				
Intrinsic safety 4 ... 20 mA / 2-wire ³						E				
customer						9				
Accuracy										
0,5 %						5				
customer						9				
Electrical connection										
Male and female plug ISO 4400						1	0	0		
Binder series 723 (5-pin)						2	0	0		
Cable gland incl. cable ^{4,5}						4	0	0		
Cable outlet ⁴						T	R	0		
Male plug Buccaneer IP68 ⁶						5	0	0		
M12x1 (4-pin)						M	0	0		
customer						9	9	9		
Mechanical connection										
G3/4" DIN 3852 with flush sensor							K	0	0	
G1 1/2" DIN 3852 with flush sensor							M	0	0	
customer							9	9	9	
Seals										
for P _N ≤ 25 bar	FKM								1	
for P _N > 25 bar	NBR								5	
for P _N ≤ 25 bar	EPDM								3	
customer									9	
Pressure port										
Stainless steel 1.4571 (316Ti)									1	
for P _N ≤ 25 bar	PVC ³								A	
for P _N ≤ 25 bar	PVDF ³								B	
customer									9	
Diaphragm										
Ceramics Al ₂ O ₃ 96%									2	
customer									9	
Special version										
standard								0	0	0
customer								9	9	9

¹ only possible for pressure port of stainless steel
² 3-wire-version only possible for mech. connection G3/4"
³ Ex-protection not possible with mech. connection G3/4" with plastic pressure port
⁴ different cable types and lengths deliverable
⁵ standard: 2 m PVC cable without ventilation tube, optionally cable with ventilation tube
⁶ cable with ventilation tube required

This ordering code contains product specification; properties are not guaranteed. Subject to change without notice.

